

**Kumanda
Kutulari**
Control Boxes

Kumanda Kutuları

Genel Özellikler ve Teknik Bilgiler	03
Kumanda Kutuları Seçim Tablosu	04
Kumanda Kutuları Kod Kombinasyonu Tablosu	05
Genel Şema	06
Tekli Kumanda Kutuları	07
İkili Plastik Kumanda Kutuları	08
Üçlü Plastik Kumanda Kutuları	09
Dörtlü Plastik Kumanda Kutuları	10
Altılı Plastik Kumanda Kutuları	11
Boyutlar	12

Control Boxes

<i>General Specifications and Technical Information</i>	<i>03</i>
<i>Control Boxes Selection Table</i>	<i>04</i>
<i>Control Box Code Combination Table</i>	<i>05</i>
<i>General Scheme</i>	<i>06</i>
<i>Single Cut-Out Control Boxes</i>	<i>07</i>
<i>Plastic Two Cut-Out Control Boxes</i>	<i>08</i>
<i>Plastic Three Cut-Out Control Boxes</i>	<i>09</i>
<i>Plastic Four Cut-Out Control Boxes</i>	<i>10</i>
<i>Plastic Six Cut-Out Control Boxes</i>	<i>11</i>
<i>Dimensions</i>	<i>12</i>

CEKP Çift El Kontrol Paneli

Genel Özellikler ve Teknik Bilgiler	13
Boyutlar	14

CEKP Two Hand Control Panel

<i>General Specifications and Technical Information</i>	<i>13</i>
<i>Dimensions</i>	<i>14</i>



Kumanda Kutuları

- Ø22 mm çaplı butonlara uygun
- Cam elyaf katkılı plastik gövde sayesinde mekanik darbelere tam dayanım
- Farklı boyutlarda 5 gövde tipi
- Renkli butonlar sayesinde kullanım kolaylığı
- Koruma sınıfının yüksek olması nedeniyle çevre şartlarına maksimum dayanım

Teknik Bilgiler

Çalışma Sıcaklığı : min./maks. °C -5/+85
Koruma Sınıfı : Uygun butonlarla IP65
Standart : TS EN 60947-5-1 VDE 0660 UL508



Butonlar

Not: Kumanda kutularının içinde kullanılan kontak blokların teknik özellikleri için bakınız sayfa A 21.

Control Boxes

- Suitable to Ø22 mm buttons
- Strong resistance against mechanical strokes through glass fibre reinforced plastic body
- 5 body types in different dimensions
- Usage facility with coloured buttons
- Maximum strength to environmental conditions with waterproof body

Technical Information

Operating Temperature : min./max. °C -5/+85
Protection Degree : IP65 with suitable buttons
Standard : TS EN 60947-5-1 VDE 0660 UL508



Buttons

Notes: See page A 21 to see the technical specifications of the contact blocks mounted in the control boxes.

Kumanda Kutuları Seçim Tablosu

Control Boxes Selection Table

Seri	1. Delik	2. Delik	3. Delik	4. Delik	5. Delik	6. Delik	Etiket
PY3	56B	07C	08H	-	-	-	A
Series	1. Cut-Out	2. Cut-Out	3. Cut-Out	4. Cut-Out	5. Cut-Out	6. Cut-Out	Label

Seri Series	YAN SAYFADAKİ P KUTU KOD KOMBİNASYONU TABLOSUNDAN RAKAM VE HARFLERİNİ KULLANARAK ÖZEL KUTU SİPARİŞ KODUNUZU YARATABİLİRSİNİZ.	Etiket Label
P1C Tek Gözlü Plastik Kumanda Kutusu Siyah-Gri Black-Grey Plastic Control Box (single cut-out)	<p>YOU CAN MAKE YOUR SPECIAL BOX ORDER CODE FROM P BOX CODE COMBINATION TABLE IN NEXT PAGE.</p>	A Etiketsiz Without Label
P1EC Tek Gözlü Plastik Kumanda Kutusu Sarı-Siyah Yellow-Black Plastic Control Box (single cut-out)		A BET08 BET08
PY1 Tek Gözlü Plastik Yüksek Kumanda Kutusu Siyah-Gri Black-Grey Plastic High Control Box (single cut-out)		B BET18 BET18
M1C Tek Gözlü Alüminyum Yüksek Kumanda Kutusu Sarı-Gri Yellow-Grey Aluminium High Control Box (single cut-out)		C BET08 - Start BET08 - Start
P2 İki Gözlü Plastik Kumanda Kutusu Siyah-Gri Black-Grey Plastic Control Box (two cut-out)		D BET08 - Stop BET08 - Stop
PY2 İki Gözlü Plastik Yüksek Kumanda Kutusu Siyah-Gri Black-Grey Plastic High Control Box (two cut-out)		E BET08-01 BET08-01
P3 Üç Gözlü Plastik Kumanda Kutusu Siyah-Gri Black-Grey Plastic Control Box (three cut-out)		F BET08-01 OK BET08-01 OK
P3EC Üç Gözlü Plastik Kumanda Kutusu Sarı-Siyah Black-Grey Plastic Control Box (three cut-out)		G BET08-201 BET08-201
PY3 Üç Gözlü Plastik Yüksek Kumanda Kutusu Siyah-Gri Yellow-Black Plastic Control Box (three cut-out)		H BET08-201 OK BET08-201 OK
P4 Dört Gözlü Plastik Kumanda Kutusu Siyah-Gri Black-Grey Plastic Control Box (four cut-out)		I BET08-201 OK 2 BET08-201 OK 2
PY4 Dört Gözlü Plastik Yüksek Kumanda Kutusu Siyah-Gri Black-Grey Plastic High Control Box (four cut-out)		K BET60P Kalıptan Kapalı Kutu İçin BET60P Closed Boxes
P6 Altı Gözlü Plastik Kumanda Kutusu Siyah-Gri Black-Grey Plastic Control Box (six cut-out)		L BET60A BET60A
PY6 Altı Gözlü Plastik Yüksek Kumanda Kutusu Siyah-Gri Black-Grey Plastic High Control Box (six cut-out)		M Özel Etiket Special Label

YAN SAYFADAKİ P KUTU KOD KOMBİNASYONU TABLOSUNDAN RAKAM VE HARFLERİNİ KULLANARAK ÖZEL KUTU SİPARİŞ KODUNUZU YARATABİLİRSİNİZ.

YOU CAN MAKE YOUR SPECIAL BOX ORDER CODE FROM P BOX CODE COMBINATION TABLE IN NEXT PAGE.

Örnek: PY3-56B07C58L-A Kodu PY3 tipi kutu 1. delikte 56. satır B sütununa denk gelen buton kodumuz 2. Delikte 07. satır C sütununa denk gelen buton kodu ve 3. Delikte 58. Satır L sütunundaki kodu sonunda da A tipi Etiketini ifade etmektedir.

Buton kodlarına buton bölümümüzden veya kodlama tablolarından bakabilirsiniz P serisi Kutularda kontak blok ve duyar bloklar C serisinden gelecektir.

Not: P, PY ve M kodlu kutularımızdan vereceğiniz özel siparişler için seçim tablosunu kullanabilirsiniz. Seçim tablosundan oluşturduğunuz özel kodlu ürünlerde siparişiniz 50 adetin altında ise demonte olarak teslim edilir.

Example: PY3-56B07C58L-A Code means :Box type is PY3 series, 1st Hole is push button where is 56. line and B colour in the next page, 2nd Hole is push button where is 7. line and C colour in the next page, 3rd Hole push button where is 58. line and L colour in the next page, Label A means BET08

You can find all Push Button Codes from Push Button parts or P Type Box Code Combination Table,

Note: You can use Selection Table for your P, PY and M Boxes orders
Special orders from the Selection Table will be delivered as dismantled if the quantity is less than 50 pcs.

Genel Şema / General Scheme

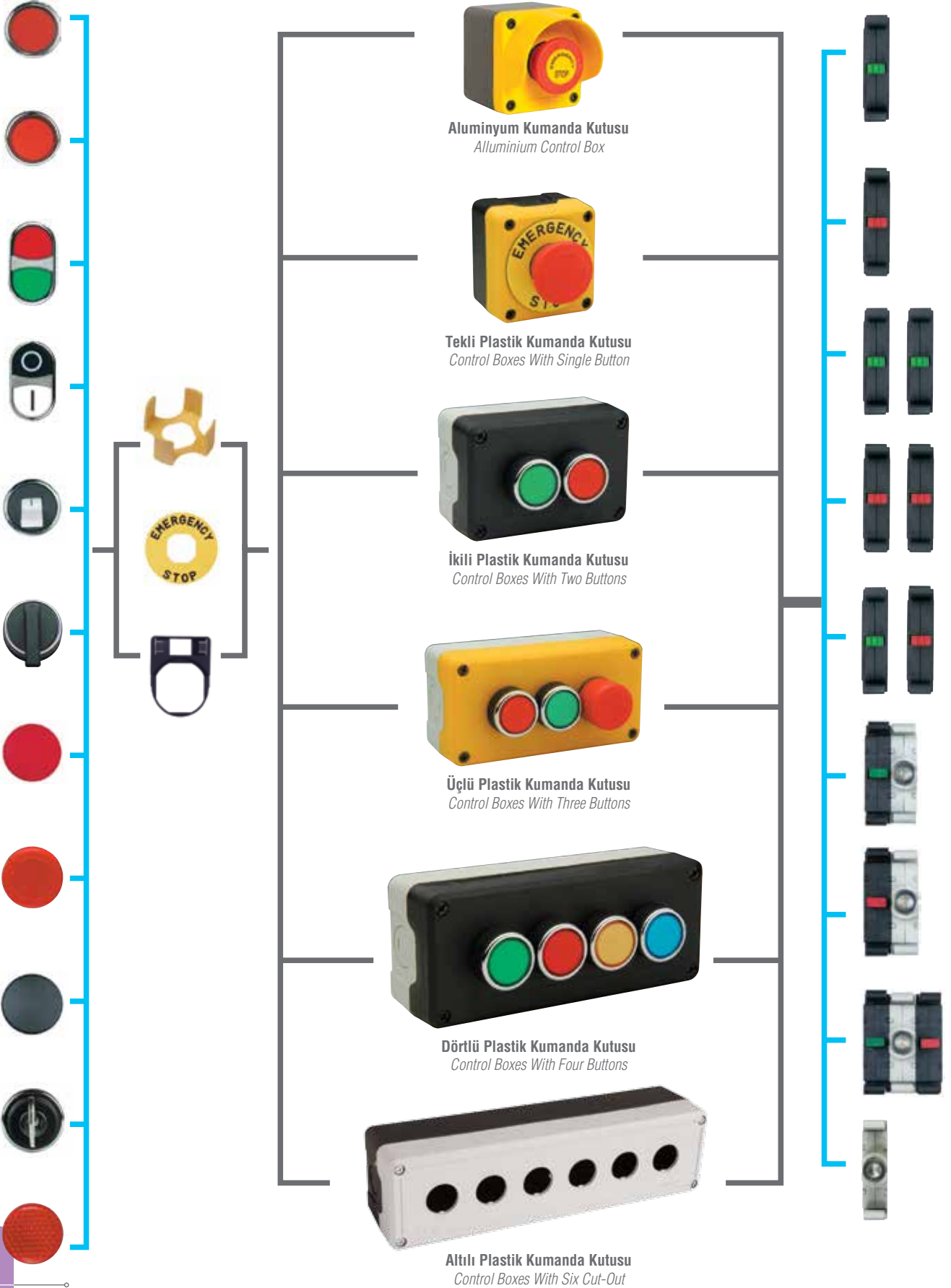

Kumanda Kutuları Control Boxes



Tekli Kumanda Kutuları / Control Boxes For One Unit

Ürün Kodu Code	Kontakt Blok Tipi Contact Block Type		Buton Tipi Button Type	Kutu Rengi Box Colour	Etiket Plate
	Normal Açık Normally Open	Normal Kapalı Normally Closed			
P1C300D*	1	-	Düz / Flush	Siyah-Gri / Black-Grey	
P1C400D*	-	1	Düz / Flush	Siyah-Gri / Black-Grey	
P1C304D*	1	1	Düz / Flush	Siyah-Gri / Black-Grey	
P1C300M*	1	-	Mantar / Mushroom	Siyah-Gri / Black-Grey	
P1C400M*	-	1	Mantar / Mushroom	Siyah-Gri / Black-Grey	
P1C304M*	1	1	Mantar / Mushroom	Siyah-Gri / Black-Grey	
P1C400E30	-	1	Acil Stop Ø30 mm / Emergency Stop Ø30 mm	Siyah-Gri / Black-Grey	
P1C304E30	1	1	Acil Stop Ø30 mm / Emergency Stop Ø30 mm	Siyah-Gri / Black-Grey	
P1C400E40	-	1	Acil Stop Ø40 mm / Emergency Stop Ø40 mm	Siyah-Gri / Black-Grey	
P1C304E40	1	1	Acil Stop Ø40 mm / Emergency Stop Ø40 mm	Siyah-Gri / Black-Grey	
P1C304K20	1	1	Çiftli, Düz / Double Headed	Siyah-Gri / Black-Grey	
P1C300S20	1	-	Seçici / Selector	Siyah-Gri / Black-Grey	
P1C303S30	2	-	Seçici / Selector	Siyah-Gri / Black-Grey	
P1C300A20	1	-	Anahtarlı / Key Operated	Siyah-Gri / Black-Grey	
P1C303A30	2	-	Anahtarlı / Key Operated	Siyah-Gri / Black-Grey	
P1EC400E30K	-	1	Acil Stop Ø30 mm / Emergency Stop Ø30 mm	Sarı-Siyah / Yellow-Black	BET60P
P1EC400E40K	-	1	Acil Stop Ø30 mm / Emergency Stop Ø30 mm	Sarı-Siyah / Yellow-Black	BET60P
P1CBOS	-	-	Boş Kutu / Empty Box	Siyah-Gri / Black-Grey	-
P1ECBOS	-	-	Boş Kutu / Empty Box	Sarı-Siyah / Yellow-Black	-
P1C400M72	-	1	Mantar / Mushroom	Siyah-Gri / Black-Grey	-
P1C400E72	-	1	Mantar / Mushroom	Siyah-Gri / Black-Grey	-

Tekli Metal Kutuları / Metal Control Boxes For One unit

Ürün Kodu Code	Kontakt Blok Tipi Contact Block Type		Buton Tipi Button Type	Kutu Rengi Box Colour	Etiket Plate
	Normal Açık Normally Open	Normal Kapalı Normally Closed			
M1C400EE	-	1	Acil Stop Ø40 mm / Emergency Stop Ø40 mm	Sarı-Gri / Yellow-Grey	-
M1CBOS	-	-	Boş Kutu / Empty Box	Sarı-Gri / Yellow-Grey	-

* Renk kodlaması için seçim tablosuna bakınız. See the selection table for colour coding.



P1C300DY

P1C304E30

P1EC400E40K

P1C400M72

P1C304K20

M1C400EE

PY1BOS

BOYUTLAR (mm) / DIMENSIONS (mm)

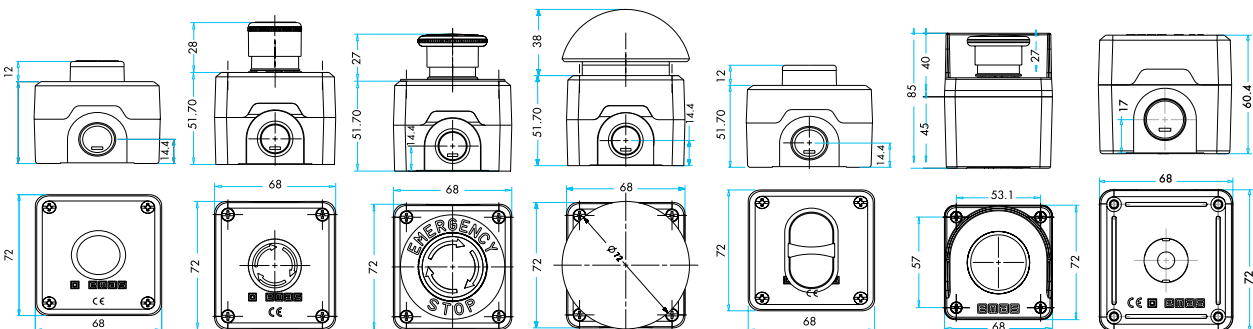

İkili Plastik Kutuları / Control Boxes For Two Units

Ürün Kodu Code	1. Buton Kontak Tipi 1. Button Contact Type		2. Buton Kontak Tipi 2. Button Contact Type		1. Buton Tipi 1. Button Type	2. Buton Tipi 2. Button Type	Etiket Plate
	Normal Açık Normally Open	Normal Kapalı Normally Closed	Normal Açık Normally Open	Normal Kapalı Normally Closed			
P2AB	1	-	-	1	Düz / Flush	Düz / Flush	-
P2ABM	1	-	-	1	Düz / Flush	Mantar Mushroom	-
P2ABE30	1	-	-	1	Düz / Flush	Acil Stop Ø30 mm Emergency Stop Ø30 mm	-
P2ABE40	1	-	-	1	Düz / Flush	Acil Stop Ø40 mm Emergency Stop Ø40 mm	-
P2CC	1	1	1	1	Düz / Flush	Düz / Flush	-
P2CCM	1	1	1	1	Düz / Flush	Mantar Mushroom	-
P2CCE30	1	1	1	1	Düz / Flush	Acil Stop Ø30 mm Emergency Stop Ø30 mm	-
P2CCE40	1	1	1	1	Düz / Flush	Acil Stop Ø40 mm Emergency Stop Ø40 mm	-
P2AC	1	-	1	1	Düz / Flush	Düz / Flush	-
P2ACM	1	-	1	1	Düz / Flush	Mantar Mushroom	-
P2ACE30	1	-	1	1	Düz / Flush	Acil Stop Ø30 mm Emergency Stop Ø30 mm	-
P2ACE40	1	-	1	1	Düz / Flush	Acil Stop Ø40 mm Emergency Stop Ø40 mm	-
P2BC	-	1	1	1	Düz / Flush	Düz / Flush	-
P2BCM	-	1	1	1	Düz / Flush	Mantar Mushroom	-
P2BCE30	-	1	1	1	Düz / Flush	Acil Stop Ø30 mm Emergency Stop Ø30 mm	-
P2BCE40	-	1	1	1	Düz / Flush	Acil Stop Ø40 mm Emergency Stop Ø40 mm	-
P2ACS30	1	-	1	1	Düz / Flush	Seçici Selector	-
P2AAA21	1	-	1	-	Düz / Flush	Anahtarlı Key Operated	-
P2ABCD	1	-	-	1	Düz / Flush	Düz / Flush	-
P2BOS	-	-	-	-	Boş Kutu / Empty Box	-	-
PY2BOS	-	-	-	-	Boş Kutu / Empty Box	-	-



P2AB



P2CCM



P2ABE40



P2ACS30



P2AAA21



PY2BOS

BOYUTLAR (mm) / DIMENSIONS (mm)

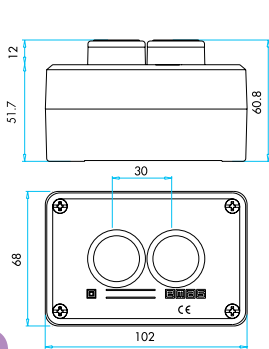

P2AB

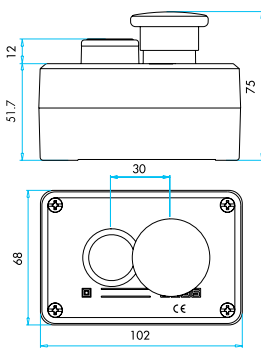

P2ACM

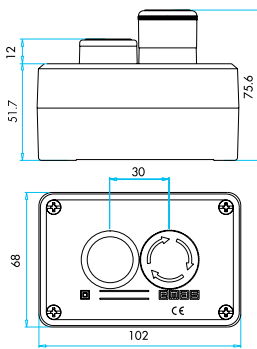

P2ABE30

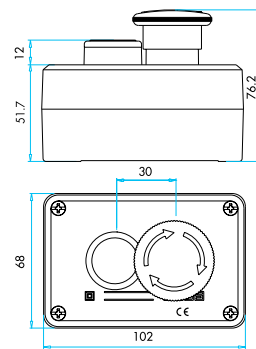

P2CCE40

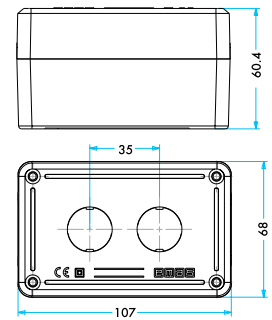

PY2BOS

Kumanda Kutuları Control Boxes



Üçlü Plastik Kumanda Kutuları / Control Boxes For Three Units

Ürün Kodu Code	Buton Kontak Tipi Button Contact Type		Buton Tipleri Button Types	Kutu Rengi Box Colour	Etiket Plate
	Normal Açık Normally Open	Normal Kapalı Normally Closed			
P33A1B	3	1	Üç Düz / Three Flush	Siyah-Gri / Black-Grey	-
P33C	3	3	Üç Düz / Three Flush	Siyah-Gri / Black-Grey	-
*P32C1B	2	3	Üç Düz / Three Flush	Gri-Siyah / Grey-Black	-
*P3EC1A2BE30	1	2	İki Düz - Bir Acil Stop Ø30 mm Two Flush; One Emergency Stop Ø30 mm	Sarı-Gri / Yellow-Grey	-
P3BOŞ	-	-	Boş Kutu / Empty Box	Siyah-Gri / Black-Grey	-
P3ECBOS	-	-	Boş Kutu / Empty Box	Sarı-Siyah / Yellow-Black	-
PY3BOS	-	-	Boş Kutu / Empty Box	Gri-Siyah / Grey-Black	-

* Özel sipariş olarak kutu rengi standart dışı yapılmıştır.

* As special order box colour is shown as non standard.



P3EC1A2BE30



P32C1B



P33A1B



PY3BOS

BOYUTLAR (mm) / DIMENSIONS (mm)

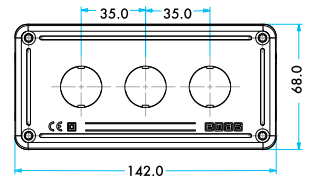
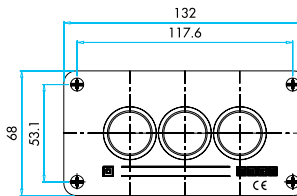
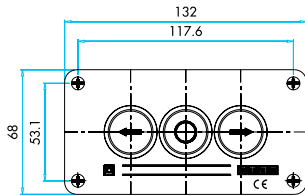
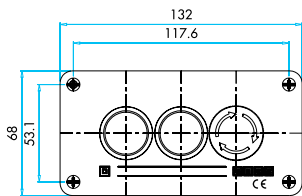
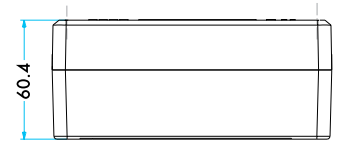
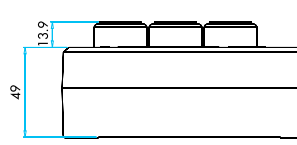
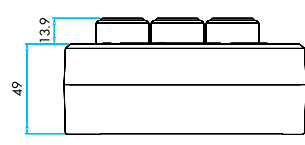
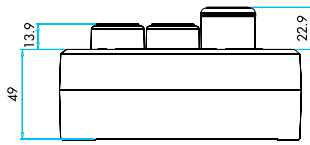

Dörtlü Plastik Kumanda Kutuları / Control Boxes For Four Units

Ürün Kodu Code	Buton Kontak Tipi Button Contact Type		Buton Tipleri Button Types	Kutu Rengi Box Colour	Etiket Plate
	Normal Açık Normally Open	Normal Kapalı Normally Closed			
P44A	4	-	Dört Düz / Four Flush	Siyah-Gri / Black-Grey	-
P44B	-	4	Dört Düz / Four Flush	Siyah-Gri / Black-Grey	-
P44C	4	4	Dört Düz / Four Flush	Siyah-Gri / Black-Grey	-
P43A1B	3	1	Dört Düz / Four Flush	Siyah-Gri / Black-Grey	-
P43A1BM	3	1	Üç Düz - Bir Mantar Three Flush - One Mushroom	Siyah-Gri / Black-Grey	-
P43A1BE30	3	1	Üç Düz - Bir Acil Stop Ø 30 mm Three Flush - One Emergency Stop Ø30 mm	Siyah-Gri / Black-Grey	-
P43A1BE40	3	1	Üç Düz - Bir Acil Stop Ø 40 mm Three Flush - One Emergency Stop Ø40 mm	Siyah-Gri / Black-Grey	-
P43A1CA30	4	1	Üç Düz - Bir Anahtarlı Three Flush - One Key Operated	Siyah-Gri / Black-Grey	-
P43A1CS30	4	1	Üç Düz - Bir Seçici Three Flush - One Selector	Siyah-Gri / Black-Grey	-
P4BOS	-	-	Boş Kutu / Empty Box	Siyah-Gri / Black-Grey	-
P41A2BE40K	1	2	İki Düz - Bir Acil Stop Ø 40 mm Two Flush - One Emergency Stop Ø40 mm	Siyah-Gri / Black-Grey	BET60P
PY4BOS	-	-	Boş Kutu / Empty Box	Siyah-Gri / Black-Grey	-



P43A1B



P43A1BE40



PY4BOS



P43A1BM



P43A1CS30



P41A2BE40K

BOYUTLAR (mm) / DIMENSIONS (mm)



P43A1B

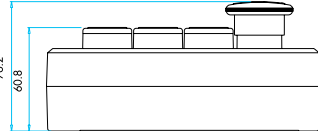

P43A1BE40

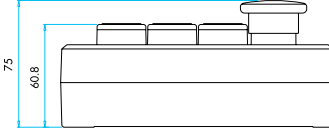

P43A1BM

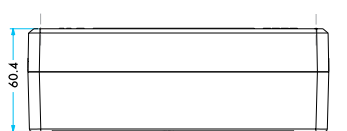

PY4BOS

Altılı Plastik Kumanda Kutuları / Control Boxes For Six Units

Ürün Kodu Code	Buton Kontak Tipi Button Contact Type		Buton Tipleri Button Types	Kutu Rengi Box Colour	Etiket Plate
	Normal Açık Normally Open	Normal Kapalı Normally Closed			
P66A	6	-	Altı Düz / Six Flush	Siyah-Gri Black-Grey	-
P66B	-	6	Altı Düz / Six Flush	Siyah-Gri Black-Grey	-
P66C	6	6	Altı Düz / Six Flush	Siyah-Gri Black-Grey	-
P65A1B	5	1	Beş Düz / Five Flush	Siyah-Gri Black-Grey	-
P65A1BM	5	1	Beş Düz - Bir Mantar Five Flush - One Mushroom	Siyah-Gri Black-Grey	-
P65A1BE30	5	1	Beş Düz - Bir Acil Stop Ø 30 mm Five Flush - One Emergency Stop Ø30 mm	Siyah-Gri Black-Grey	-
P65A1BE40	5	1	Beş Düz - Bir Acil Stop Ø 40 mm Five Flush - One Emergency Stop Ø40 mm	Siyah-Gri Black-Grey	-
P65A1CA30	6	1	Beş Düz - Bir Anahtarlı Five Flush - One Key Operated	Siyah-Gri Black-Grey	-
P65A1C-S30	6	1	Beş Düz - Bir Seçici Five Flush - One Selector	Siyah-Gri Black-Grey	-
P6BOS	-	-	Boş Kutu / Empty Box	Siyah-Gri Black-Grey	-
P65A2BE40E	5	2	Beş Düz - Bir Acil Stop Ø 40 mm Etiketli Five Flush - One Emergency Stop Ø40 mm With Label	Siyah-Gri Black-Grey	-
PY6BOS	-	-	Boş Kutu / Empty Box	Siyah-Gri Black-Grey	-



P65A1B



P65A1BE40



P64A2BE40E



PY6BOS



P65A1BM



P65A1CS30

BOYUTLAR (mm) / DIMENSIONS (mm)

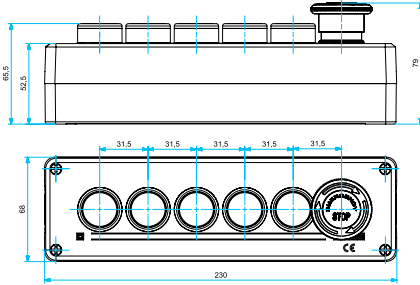

P65A2BE40E

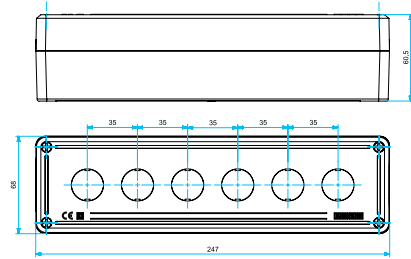

PY6B0S

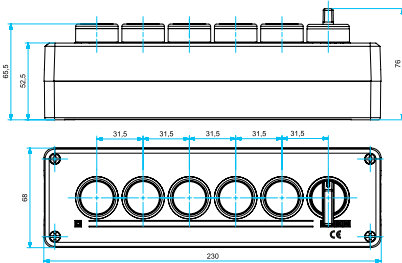

P65A1CS30

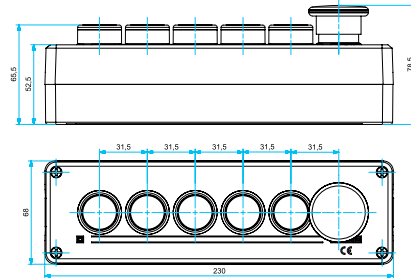

P65A1BM

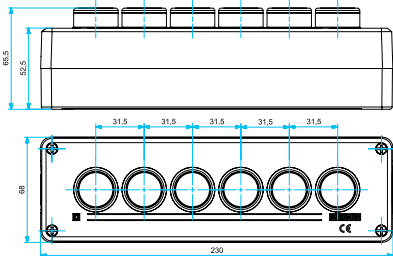

P65A1B

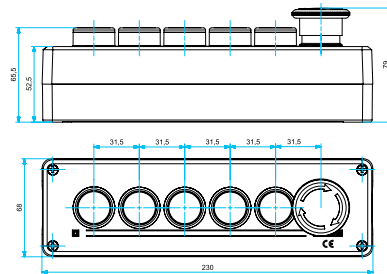

P65A1BE40



CEKP Çift El Kontrol Paneli

- Metal muhafaza
- Masa ve duvar montajı mümkün
- Ø40 mm çaplı acil stop butonu
- 2 adet çalışma butonu
- 3 ya da 5 delik alternatifli

Teknik Bilgiler

Koruma Sınıfı	: IP65
Nominal İzolasyon Gerilimi Ui	: 660 V
Termal Test Akımı	: 10 A
Kullanım Kategorisi	: AC-15 250 V / 4 A
Bağlantı Tipi	: Vida bağlantısı
Gövde Malzemesi	: Alüminyum
Ağırlık	: 4.000 g
Boyutlar	: Genişlik 425 mm, Derinlik 130 mm, Yükseklik 187 mm
Standart	: IEC/EN60947-5-5, EN ISO 13850, EN574

CE

CEKP Two Hand Control Panel

- Metal protection
- Suitable for mounting on the wall or table
- Ø40 mm emergency stop button
- 2 operation buttons
- 3 or 5 holes alternatives

Technical Information

Protection Degree	: IP65
Nominal Isolation Voltage Ui	: 660 V
Thermal Test Current	: 10 A
Category of Use	: AC-15 250 V / 4 A
Connection Type	: Screw connection
Body Material	: Aluminium
Weight	: 4.000 g
Dimensions	: Width 425 mm, Depth 130 mm, Height 187 mm
Standard	: IEC/EN60947-5-5, EN ISO 13850, EN574

CE

Kumanda Kutuları Control Boxes

EMES®



CEKPB

Ürün Kodu Code	Buton Button	Ayak Pedestal
CEKP3	3 Delikli / 3 Cut-Out	
CEKP3G	3 Delikli, Gri / 3 Cut-Out, Grey	
CEKP 5	5 Delikli / 5 Cut-Out	
CEKPA	3 Delikli / 3 Cut-Out	✓
CEKPB	1 adet CP200E (orta), 2 adet CM200MY (2 yan) 1 x CP200E (middle), 2 x CM200MY (2 sides)	
CEKPAB	1 adet CP200E (orta), 2 adet CM200MY (2 yan) 1 x CP200E (middle), 2 x CM200MY (2 sides)	✓

Ürün Kodu Code	Aksesuar Accessory
CEKA	Çift El Kontrol Paneli İçin Ayarlanabilir Ayak Adjustable Pedestal For Two Hand Control Panel

BOYUTLAR (mm) / DIMENSIONS (mm)

